



Dear customer,

Congratulations on choosing the Noctua NF-A6x15 FLX.

We at Noctua always strive to achieve superior quiet cooling performance regardless of whether it's a big 200mm fan or a small 40mm one. That's why the NF-A6x15 FLX sports many of the features and advanced aerodynamic design measures of our award-winning larger models, making it perhaps the most thoroughly optimised 60mm fan on the market.

Each Noctua fan is double-checked for flawless operation by our quality control team before it leaves the factory and I'm confident that you will be able to sense some of the research, attention and care we've put into making this product.

Enjoy your NF-A6x15 FLX!

Yours sincerely,



Roland Mossig, Noctua CEO

This document includes some instructions for installing, running and cleaning your NF-A6x15 FLX.

Should you encounter any difficulties, please check the FAQs on our website ([faq.noctua.at](https://www.noctua.at/faq)) and don't hesitate to contact our support team at support@noctua.at.

Multilingual versions of this manual are available on our website: www.noctua.at/manuals

Included mounting parts:

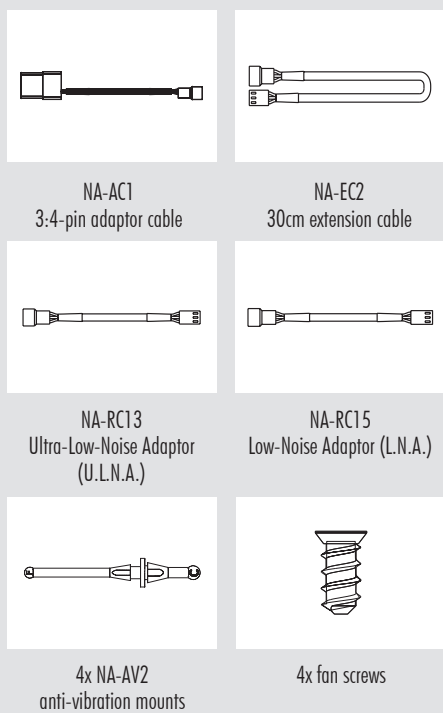

1 Installation

If you replace an existing 60mm fan with the NF-A6x15 FLX in devices such as storage or network solutions, it is usually best to use the screws (or other mounting mechanism) used for the original fan.

Depending on the application, it may also be possible to use the supplied mounting screws or silicone anti-vibration mounts.

For installing the fan using the NA-AV2 mounts, please first pull the F side through the fan's mounting holes and then pull the C side through the mounting holes of the case:

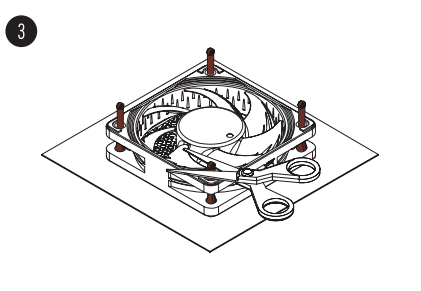
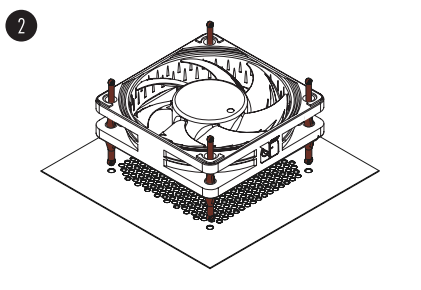
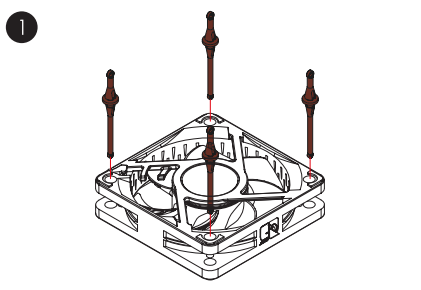
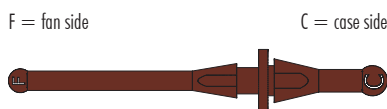

If the long ends of the mounts are in the way, you can use scissors to cut them after installation. Note that this will then make them difficult to reinstall in the future.

2 Connection

The NF-A6x15 FLX features a standard 3-pin fan connector. Please note that the fan can also be connected to 4-pin motherboard fan headers though. If you would like to connect the fan directly to your power supply, please use the supplied 3:4-pin adaptor (NA-AC1).

The NF-A6x15 FLX features a short 20cm primary cable in order to help you minimise cable clutter in typical applications. If you need a longer cable, please add the supplied 30cm extension (NA-EC2).

The NF-A6x15 FLX comes with Low-Noise (NA-RC15) and Ultra-Low-Noise Adaptors (NA-RC13) that allow you to reduce the fan speed from 3500 to 3050rpm (NA-RC15) and 2250rpm (NA-RC13) in order to achieve even quieter operation.

3 Cleaning and maintenance

In order to maintain maximum performance, please clean your fans regularly using a duster, slightly moist tissue or canned air. Please be careful not to use too much force in order to prevent any damage to the fan. Please don't use a vacuum cleaner as this may apply excessive force to the fan.

In order to ensure flawless operation over many years of usage, the NF-A6x15 FLX's premium grade SSO2 bearing is fully sealed to prevent the entering of fine dust particles.

Please note that the fan is not designed to be taken apart by the user. Removing the impeller from the frame will break the sealing of the bearing and results in a loss of warranty.

! Warranty, support and FAQs

Even with high-grade products and strict quality control, the possibility of defects cannot be eliminated entirely. Therefore, we aim at providing the highest possible level of reliability and convenience by offering a warranty period of 6 years and direct, fast and straightforward RMA service.

Should you encounter any problems with your NF-A6x15 FLX, please don't hesitate to contact our support team (support@noctua.at).

Please also consult the FAQ section on our website: [faq.noctua.at](https://www.noctua.at/faq)