

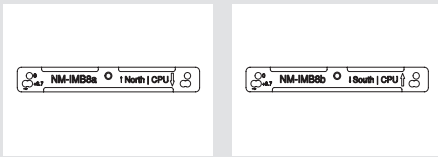

Required mounting parts:



NM-IMB8a
mounting bar

NM-IMB8b
mounting bar

Included with the cooler:

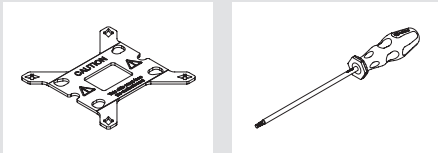

NM-IBP4
backplate

NM-SD1
or other Torx® T20
screwdriver

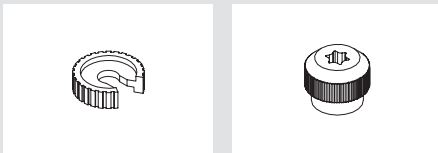

4x NM-ICS1
clip-on spacers

4x NM-STS1-TX
thumb screws

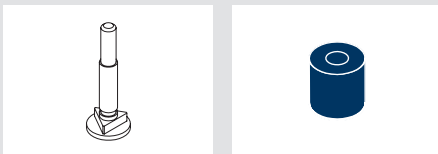

4x NM-IBT5
bolts

4x NM-IPS3
blue plastic spacers

Use the +3.7mm offset position with the additional sideways shift (north + east offset) for optimal performance on 24- or 20-core LGA1851 CPUs. In case of compatibility restrictions (e.g. RAM clearance), use the +3.7mm position (north only offset) without sideways offset or, if this is not feasible, use the standard position without offset (0).

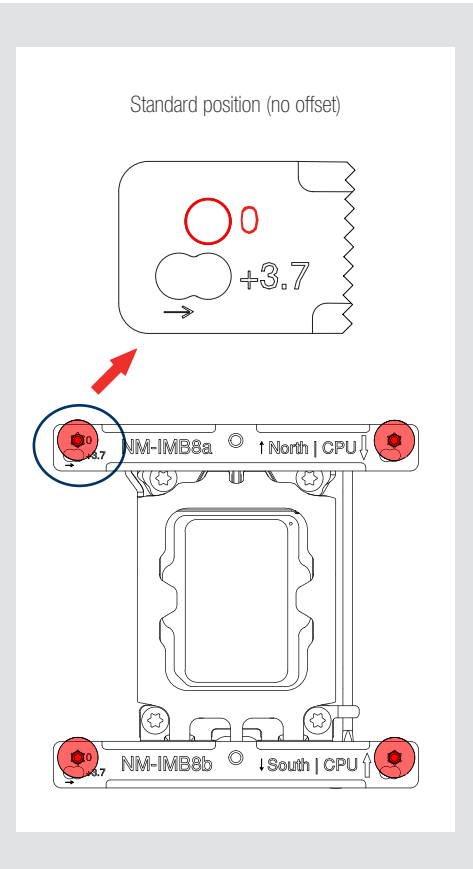
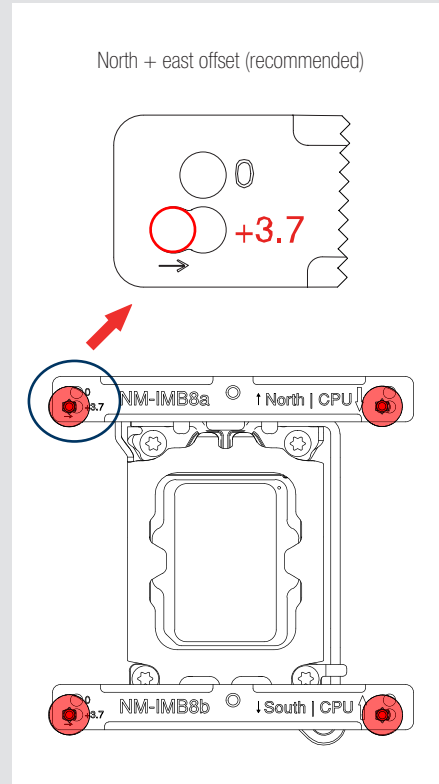

Caution: Make sure that the "CPU ↓" and "CPU ↑" markings point towards the CPU and that the NM-IMB8a bar with the "NORTH" marking is installed on the north (top) side of the socket and the NM-IMB8b bar with the "SOUTH" marking is installed on the south (bottom) side of the socket.

Fix the offset bars using the thumb screws that came with the cooler.

Caution: Gently tighten the screws until they stop, but do not use excessive force (max. torque 0.6 Nm).

Once you have screw-fixed the offset mounting bars, proceed by applying thermal paste and installing the cooler to the mounting bars, as described in the manual that came with the cooler.

! Caution

If your CPU cooler is already installed, please first unscrew it from the original mounting bars. Then, unscrew the thumbscrews and remove the original mounting bars.

If your CPU cooler is not yet installed, please install the backplate and plastic spacers as described in the manual that came with the cooler.

1 Installing the mounting bars

Install the offset mounting bars as shown below:

